

Public Document Pack

Blackpool Council

22 December 2015

To: Councillors Maycock, Ryan and L Taylor

The above members are requested to attend the:

LICENSING PANEL

Monday, 11 January 2016 at 6.00 pm
in Committee Room A, Town Hall, Blackpool

A G E N D A

1 APPOINTMENT OF CHAIRMAN

To appoint a Chairman for the meeting.

2 DECLARATION OF INTEREST - LICENSING

Members are asked to declare any interests in the items under consideration and in doing so state:-

(1) the type of interest concerned

(2) the nature of the interest concerned; and

(3) whether they have or have not sat on a Planning Committee which has previously considered a planning application in respect of a licensed premises which is also subject to consideration for a premises licence as part of the agenda for this meeting.

If any Member requires advice on declarations of interests, they are advised to contact the Head of Democratic Governance in advance of the meeting.

(Members are asked to also pay particular attention to the guidance sheet on interests supplied with the agenda).

3 PROCEDURE FOR THE MEETING

The Chairman of the Panel will summarise the procedure and announce the equal maximum amount of time for each party to speak for the hearing.

- A. Items 1 and 4 (b) will be undertaken in private session by the Panel and not in the Meeting Room.
- B. Items 2, 3, 4(a) and 4(c) will be recommended to the Panel to be held in public.
- C. The Panel may decide to exclude the public from all or part of a hearing where it considers that the public interest in so doing outweighs the public interest in the hearing, or that part of the hearing, taking place in public. (This includes a party and any person assisting or representing a party)

4 APPLICATION FOR A PREMISES LICENCE- ABINGDON NEWS (Pages 1 - 34)

- a. APPLICATION AND REPRESENTATIONS SUBMITTED. To consider the attached report
- b. DETERMINATION OF THE APPLICATION FOR A PREMISES LICENCE- Abingdon News
- c. ANNOUNCEMENT OF THE DECISION FOR THE TRANSFER OF A PREMISES LICENCE- Abingdon News

Venue information:

First floor meeting room (lift available), accessible toilets (ground floor), no-smoking building.

Other information:

For queries regarding this agenda please contact Lennox Beattie, Executive and Regulatory Manager, Tel: 01253 477157, e-mail lennox.beattie@blackpool.gov.uk

Copies of agendas and minutes of Council and committee meetings are available on the Council's website at www.blackpool.gov.uk.

Report to:	Licensing Panel
Relevant Officer:	Sharon Davies, Head of Licensing Services
Date of Meeting :	11 th January 2016

APPLICATION FOR A PREMISES LICENCE – ABINGDON NEWS

1.0 Purpose of the report:

- 1.1 To consider an application for a Premises Licence at Abingdon News, Unit 13 Abingdon Market Blackpool.

2.0 Recommendation(s):

- 2.1 The panel is requested to consider the application and determine whether the granting of this licence would adversely impact on the licensing objectives.

3.0 Reasons for recommendation(s):

- 3.1 Representations have been received therefore there must be a hearing to determine the application.

- 3.2a Is the recommendation contrary to a plan or strategy adopted or approved by the Council? No

- 3.2b Is the recommendation in accordance with the Council's approved budget? Yes

- 3.3 Other alternative options to be considered:

None, once an application is submitted and representations received it must be considered by the Licensing Panel.

4.0 Background Information

- 4.1 On 2nd November 2015, the Licensing Service received an application from Santhosh Puthusseri to issue a Premises Licence at Abingdon News, Unit 13 Abingdon Market Blackpool.

- 4.2 The application requests permission to sell alcohol for consumption off the premises

08.30 – 17.00 hours daily. A copy of the application is attached at Appendix 4a.

4.3 Representations have been received from Lancashire Constabulary, Public Health, the Licensing Authority, and Weights and Measures. Copies of the representations are attached.

4.4 **Local policy considerations**

This premises is situated within Talbot Ward which is one for four wards that form part of the off-licence saturation policy. The effect of this policy is to create a rebuttable presumption that applications will be refused. To rebut this presumption, an applicant would be expected to show through the operating schedule, and where appropriate with supporting evidence, that the operation of the premises will not add to the cumulative impact already being experienced. The following sections of the policy are relevant:

4.8.3 This policy does not act as an absolute prohibition on the granting of new off-licences however, the policy will only be overridden in genuinely exceptional cases where the applicant can demonstrate that the granting of the application will not undermine the policy and the reasons for it.

4.8.4 An application is not likely to be classed as exceptional merely on the ground that the premises have been or will be operated within the terms of its licence or that they are/will be well managed. This is to be expected of any application.

4.5 **National policy considerations**

9.12 – The police are an essential source of advice and information on the impact and potential impact of licensable activities, particularly on the crime and disorder objective. The licensing authority should accept all reasonable and proportionate representations made by the police unless the authority has evidence that do so would not be proportionate for the promotion of the licensing objectives.

9.42 – The authority’s decision should be evidence-based, justified as being appropriate for the promotion of the licensing objectives and proportionate to what it is intended to achieve.

13.35 – After receiving relevant representations in relation to a new application for or a variation of a licence or certificate, the licensing authority must consider whether it would be justified in departing from its special policy in the light of the individual circumstances of the case... if the licensing authority decides that an application should be refused, it will still need to show that the grant of the application would undermine the promotion of one of the licensing objectives and that appropriate conditions would be ineffective in preventing the problems involved.

4.6 Observations

This unit in Abingdon Street Market was previously licensed, the licence holder being Mrs Kailasben Gandhi. Whilst this licence was in her name it was subject to two reviews. The first review was in November 2012 dealing with sales of alcohol to street drinkers when the licence holder had been asked not to. Conditions were added onto the licence as a result of this review. The second review was submitted in January 2015 following the seizure of counterfeit vodka. At a hearing on 24th April 2015 a Licensing Panel determined to revoke the licence having concluded that Mrs Gandhi was an irresponsible trader. This decision to revoke was upheld by the Magistrates' Court at a hearing on 17th August 2015.

The Licensing Service has concerns that Mr and Mrs Gandhi are still involved in the business at Stall 13. Mr Gandhi submitted the initial application to the Licensing Service on behalf of the applicant. Furthermore officers, when checking the site notice on 10th November 2015, spoke to Mr Gandhi at the stall. Officers also recall a telephone conversation with Mr Puthusseri on 20th November 2015 when he said that it was Mr Gandhi's shop and he would be handing it over to him next month. When asked for clarification he confirmed that Mr Gandhi would be transferring the licence into his name when it was granted.

The panel will also note that the applicant, and proposed Designated Premises Supervisor, lives in London. Whilst it is possible for the licence holder and Designated Premises Supervisor to reside out of the area, the panel, if satisfied that it is the applicant's intention to operate the business himself, may be concerned about the location of the proposed Designated Premises Supervisor bearing in mind the concerns expressed during the previous two reviews about the poor management at the premises.

4.7 Does the information submitted include any exempt information? No

4.8 List of Appendices:

Appendix 4a: Application
Appendix 4b: Representation from Lancashire Constabulary
Appendix 4c: Representation from Public Health
Appendix 4d: Representation from the Licensing Authority
Appendix 4e: Representations from Weights and Measures

5.0 Legal considerations:

5.1 Please see local and national policy in the background information.

6.0 Human Resources considerations:

6.1 None

7.0 Equalities considerations:

7.1 None

8.0 Financial considerations:

8.1 None



Blackpool Council

02 NOV 2015

APPLICATION FOR A NEW PREMISES LICENCE

Applicant Name(s):

MR. SANTHOSH PUTHUSSERI

Contact

Licensing Service
Blackpool Council
Municipal Buildings, PO Box 4
Blackpool, FY1 1NA

T: (01253) 47 8572 / 8589
F: (01253) 47 8372

www.blackpool.gov.uk



2

Application for a premises licence to be granted under the Licensing Act 2003

PLEASE READ THE FOLLOWING INSTRUCTIONS FIRST

Before completing this form please read the guidance notes at the end of the form.
 If you are completing this form by hand please write legibly in block capitals. In all cases ensure that your answers are inside the boxes and written in black ink. You may wish to keep a copy of the completed form for your records.

I/We MR. SANTHOSH PUTHUSSERI
[insert name of applicant/s]

apply for a premises licence under Schedule 17 of the Licensing Act 2003 for the premises described under Part 1 below and I/we are making this application to you as the relevant licensing authority in accordance with section 12 of the Licensing Act 2003.

Part 1 – Premises Details

Postal address of premises or club premises if any, or if none the ordinance survey map reference or description.					
Premises Name	ABINGOON NEWS UNIT 13 STALL				
Premises Address	MRS. KALLASTHEN GANDHY ABINGOON STREET MARKET				
	ABIM BLACK POOL				
	Post Code	F	Y	1	1 D E
Telephone Number of premises (if any)	01253290131				
E-Mail Address					
Non-Domestic Rateable Value of Premises	£ 3000				

Part 2 – Applicant details

In what capacity are you applying for a licence?

Please tick:

- | | | |
|---|-------------------------------------|--------------------|
| a) An individual * | <input checked="" type="checkbox"/> | Complete Section A |
| b) A person other than an individual* | | |
| I. As a limited company | <input type="checkbox"/> | Complete Section B |
| II. As a partnership | <input type="checkbox"/> | Complete Section B |
| III. As an unincorporated association | <input type="checkbox"/> | Complete Section B |
| IV. Other (for example a statutory corporation) | <input type="checkbox"/> | Complete Section B |
| c) A recognised Club | <input type="checkbox"/> | Complete Section B |
| d) A charity | <input type="checkbox"/> | Complete Section B |
| e) The proprietor of an educational establishment | <input type="checkbox"/> | Complete Section B |

- f) Health Service Body Complete Section B
- g) A person who is registered under Part 2 of the Care Standards Act 2000 (c14) in respect of an independent hospital in Wales Complete Section B
- ga) A person who is registered under Chapter 2 of Part 1 of the Health and Social Care Act 2008 in respect of the carrying on of a regulated activity (within the meaning of that Part) in an independent Hospital in England. Complete Section B
- h) The Chief Officer of Police of a police force in England and Wales Complete Section B

***If you are applying as a person described in (a) or (b) please confirm:**

- I am carrying on or propose to carry on business that involves the use of the premises for licensable activities; or If yes please tick
- I am making the application pursuant to a
 - Statutory function
 - A function discharged by virtue of Her Majesty's prerogative

(A) Individual Applicants (fill in as applicable)

Title:	Mr	Mrs	Miss	Ms	MR		
Surname	PUTHUSSERI				Forenames	SANTHOSH	
I am 18 years old or over	Yes	No	Date of Birth		<small>Please tick</small>		
	✓						
Home Address							
	BARKING						
						Post Code	
Telephone Number					Mobile Number		
E-Mail Address							

SECOND INDIVIDUAL APPLICANT IF APPLICABLE

Title:	Mr	Mrs	Miss	Ms	
Surname				Forenames	
Date of Birth	Day	Month	Year	I am 18 years old or over	Please tick Yes No
Home address					
				Post Code	
Telephone Number				Mobile Number	
E-Mail Address					

(B) OTHER APPLICANTS

Please provide name and registered address of the applicant in full. Where appropriate please give any registered number. In the case of a partnership or other joint venture (other than a body corporate), please give the name and address of each party concerned.

Name					
Address					
				Post Code	
Telephone Number					
E-Mail Address					
Registered number (where applicable)					
Description of applicant (e.g. partnership, company, unincorporated association)					

Part 3 - Operating Schedule

ASAP

When do you want the premises licence to start

Day	Month	Year
0	1	2015

If you wish the licence to be valid only for a limited period, when do you want it to end?

Day	Month	Year
0	1	2010

If 5000 or more people are expected to attend the premises at any one time, please state the number expected to attend

Please give a general description of the premises (Please see guidance note 1)

It is a small shop inside a Market. Starting from 8.30 A.M to 5.00 P.M. In total there is ~~20~~ 50 shops, in that shops it is a small shop. It is an - off Licence shop, Groceries, juices, snacks, ~~etc~~ News Papers, confectionery, soft drinks. ~~For the number of years~~ this is corner stall which have metal shutters to close After trading hours. Most of our customers are ~~elderly~~ elderly local customers and visitors during the season. Period in Blatford because the market open 8.30 AM to 5.00 PM. We don't get any clubbing and stag / hen party people. the custom we get getting ~~and~~ people they buy and take home.

What licensable activities do you intend to carry on from the premises?
 (Please see sections 1 and 14 of the Licensing Act 2003 and Schedule 1 and 2 to the Licensing Act 2003)

Provision of regulated entertainment:

If yes please tick

- a) A performance of a play (if ticking yes, fill in box A)
- b) An exhibition of a film (if ticking yes, fill in box B)
- c) An indoor sporting event (if ticking yes, fill in box C)
- d) Boxing or wrestling entertainment (if ticking yes, fill in box D)
- e) A performance of live music (if ticking yes, fill in box E)
- f) Any playing of recorded music (if ticking yes, fill in box F)
- g) A performance of dance (if ticking yes, fill in box G)
- h) Entertainment of a similar description to that falling within (e), (f) or (g) (if ticking yes, fill in box H)

Provision of late night refreshment (if ticking yes, fill in box I)

Supply of alcohol (if ticking yes, fill in box J)

In all cases complete boxes K, L and M

A

Performance of a play Standard timings (read guidance note 6)			Will the performance of a play take place indoors, outdoors or both? Please tick. (Read guidance note 2)	Indoors	
Day	Start	Finish		Outdoors	
Mon			<u>Please give further details here</u> (please read guidance note 3)	Both	
Tue					
Wed			<u>State any seasonal variations for performing plays</u> (please read guidance note 4)		
Thurs					
Fri			<u>Non-standard timings. Where you intend to use the premises for the performance of a play at different times to those listed in the column on the left, please list</u> (please read guidance note 5)		
Sat					
Sun					

B

Exhibition of film Standard timings (read guidance note 6)			Will the exhibition of films take place indoors, outdoors or both? Please tick. (Read guidance note 2)	Indoors	
				Outdoors	
				Both	
Day	Start	Finish	Please give further details here (please read guidance note 3)		
Mon					
Tue			State any seasonal variations for the exhibition of films (please read guidance note 4)		
Wed					
Thurs			Non-standard timings. Where you intend to use the premises for the exhibitions of film at different times to those listed in the column on the left, please list (please read guidance note 5)		
Fri					
Sat					
Sun					

C

Indoor sporting events Standard timings (read guidance note 6)			Please give further details here (please read guidance note 3)		
Day	Start	Finish	State any seasonal variations for indoor sporting events (please read guidance note 4)		
Mon					
Tue			Non-standard timings. Where you intend to use the premises for indoor sporting events at different times to those listed in the column on the left, please list (please read guidance note 5)		
Wed					
Thurs					
Fri					
Sat					
Sun					

D

Boxing or wrestling entertainment Standard timings (read guidance note 6)			Will the boxing or wrestling entertainment take place indoors, outdoors or both? Please tick. (Read guidance note 2)		Indoors	
					Outdoors	
			Both			
Day	Start	Finish	Please give further details here (please read guidance note 3)			
Mon						
Tue						
Wed			State any seasonal variations for boxing or wrestling entertainment (please read guidance note 4)			
Thurs						
Fri						
Sat			Non-standard timings. Where you intend to use the premises for boxing or wrestling entertainment at different times to those listed in the column on the left, please list (please read guidance note 5)			
Sun						

E

Performance of live music Standard timings (read guidance note 6)			Will the performance of live music take place indoors, outdoors or both? Please tick. (Read guidance note 2)		Indoors	
					Outdoors	
			Both			
Day	Start	Finish	Please give further details here (please read guidance note 3)			
Mon						
Tue						
Wed			State any seasonal variations for the performance of live music (please read guidance note 4)			
Thurs						
Fri						
Sat			Non-standard timings. Where you intend to use the premises for the performance of live music at different times from those listed in the column on the left, please list (please read guidance note 5)			
Sun						

F

9

Playing of recorded music Standard timings (read guidance note 6)			Will the playing of recorded music take place indoors, outdoors or both? Please tick. (Read guidance note 2)	Indoors	
				Outdoors	
Day	Start	Finish		Both	
Mon			Please give further details here (please read guidance note 3)		
Tue					
Wed			State any seasonal variations for playing recorded music (please read guidance note 4)		
Thurs					
Fri			Non-standard timings. Where you intend to use the premises for the playing of recorded music at different times to those listed in the column on the left, please list (please read guidance note 5)		
Sat					
Sun					

G

Performance of dance Standard timings (read guidance note 6)			Will the performance of dance take place indoors, outdoors or both? Please tick. (Read guidance note 2)	Indoors	
				Outdoors	
Day	Start	Finish		Both	
Mon			Please give further details here (please read guidance note 3)		
Tue					
Wed			State any seasonal variations for the performance of dance (please read guidance note 4)		
Thurs					
Fri			Non-standard timings. Where you intend to use the premises for the performance of dance at different times to those listed in the column on the left, please list (please read guidance note 5)		
Sat					
Sun					

H

16

Entertainment of a similar description to that falling within (e), (f) or (g) Standard timings (read guidance note 6)			Please give a description of the type of entertainment you will be providing		
Day	Start	Finish	Will this entertainment take place indoors, outdoors or both. Please tick. (Read guidance note 2)	Indoors	
Mon				Outdoors	
				Both	
Tue			Please give further details here (please read guidance note 3)		
Wed					
Thu			State any seasonal variations for entertainment (please read guidance note 4)		
Fri					
Sat			Non-standard timings. Where you intend to use the premises for the entertainment at different times to those listed in the column on the left, please list (please read guidance note 5)		
Sun					

I

Late Night Refreshment Standard timings (read guidance note 6)			Will the provision of late night refreshment take place indoors, outdoors or both? Please tick (Read guidance note 2).	Indoors	
Day	Start	Finish		Outdoors	
				Both	
Mon			Please give further details here (please read guidance note 3)		
Tue					
Wed					
Thu			State any seasonal variations for the provision of late night refreshment (please read guidance note 4)		
Fri					
Sat			Non-standard timings. Where you intend to use the premises for the provision of late night refreshment at different times to those listed in the column on the left, please list (please read guidance note 5)		
Sun					

Supply of alcohol Standard timings (read guidance note 6)			Will the sale of alcohol be for consumption on the premises, off the premises or both? Please tick. (Read guidance note 6)	On the premises		
Day	Start	Finish		Off the premises	<input checked="" type="checkbox"/>	
			Both	<input type="checkbox"/>		
Mon	8.30 A.M.	5.00 P.M.	State any seasonal variations for the supply of alcohol (please read guidance note 4)			
Tue	8.30 A.M.	5.00 P.M.				
Wed	8.30 A.M.	5.00 P.M.				
Thurs	8.30 A.M.	5.00 P.M.			Non-standard timings. Where you intend to use the premises for the supply of alcohol at different times to those listed in the column on the left, please list (please read guidance note 5)	
Fri	8.30 A.M.	5.00 P.M.				
Sat	8.30 A.M.	5.00 P.M.				
Sun						

K

Please highlight any adult entertainment or services, activities, other entertainment or matters ancillary to the use of the premises that may give rise to concern in respect of children (Please read guidance note 8)

L

12

Hours premises are open to public Standard timings (read guidance note 6)			State any seasonal variations (please read guidance note 4)
Day	Start	Finish	
Mon	8.30 A.M	5.00 P.M	
Tue	8.30 A.M	5.00 P.M	
Wed	8.30 A.M	5.00 P.M	
Thurs	8.30 A.M	5.00 P.M	
Fri	8.30 A.M	5.00 P.M	
Sat	8.30 A.M	5.00 P.M	Non-standard timings. Where you intend the premises to be open to the public at different times to those listed in the column on the left, please list (please read guidance note 5)
Sun			

M

State the name and details of the individual whom you wish to specify on the licence as the designated premises supervisor.			
Surname	PUTHUSSERI		Forename(s) SANTHOSH
State any previous names			
They are 18 years old or over	Yes	No	Their Date of Birth
	<input checked="" type="checkbox"/>	<input type="checkbox"/>	
<small>Please tick</small>			
Address			
	BARKING		
	Post Code		
Telephone Number			
Email Address			
Personal Licence Number (if known)	035599		
Expiry date of Personal Licence			
Issuing Licensing Authority (if known)	10/07/2015, LONDON BOROUGH OF BARKING & DAGENHAM		

Describe the steps you intend to take to promote the four licensing objectives:

a) General - all four licensing objectives (b,c,d,e) (See guidance note 9)

- 1) Inside and outside of the premises is fully covered by CCTV cameras.
- 2) Not overstock the shelf.
- 3) Premises shut on time; no deliveries or collection before or after 08.30 or 17.00 hrs.
- 4) Strictly advise to the staff not to serve alcohol to the under age customers to check the Nat. Proof ID. However, challenge 25.

b) The prevention of crime and disorder

- 1) Inside and outside of the premises is fully covered by CCTV cameras.
- 2) The complete exclusion of any person under the age of 18.
- 3) Not open the premises outside the licensed hours.
- 4) Store alcohol in secured place.
- 5) Premises fully locked, alarmed after close shop.

c) Public Safety

- 1) Not over stock in the shelf.
- 2) Not serve alcohol to any person already drunk.
- 3) Not open for trading outside the licensed hours.
- 4) Using strong carrier bag for packing.
- 5) Refuse to serve any person under age, if any doubt of the age then proof of age (ID) follow. Challenge 25 & Refusal Book.

d) The prevention of public nuisance

- 1) Inside and outside of the premises is 24 hours covered by CCTV cameras.
- 2) Ensuring that deliveries, collection and other carried out between 08.30 and 17.00 hours.
- 3) Premises shut on time.

e) The protection of children from harm

- 1) Staff being strongly advised not to serve sell alcohol age drinker, always has to be checked the proof of age ID.
- 2) Keeping the alcohol, spirits unreachably self serving areas.
- 3) If we think a customer buy alcohol on behalf of child refuse to sell.
- 4) If any of children come at once to the shop ask to leave shop. Kinary Even self ID.

If yes please

- I have made or enclosed payment of the fee
- I have enclosed the plan of the premises
- I have sent copies of this application, including the plan and consent by the proposed supervisor form (if applicable), to the responsible authorities
- I have enclosed the consent form completed by the individual I wish to be premises supervisor, if applicable
- I understand that I must now advertise my application. *(You may be asked to prove this, it is therefore in your best interests to provide a copy of the advert to the Licensing Department).*
- I understand that if I do not comply with the above requirements my application will be rejected

IT IS AN OFFENCE, LIABLE ON CONVICTION TO A FINE UP TO LEVEL 5 ON THE STANDARD SCALE, UNDER SECTION 158 OF THE LICENSING ACT 2003 TO MAKE A FALSE STATEMENT IN OR IN CONNECTION WITH THIS APPLICATION

Part 5 – Signatures (please read guidance note 10)

Signature of applicant or applicant's solicitor or other duly authorised agent. (please read guidance note 11) **If signing on the behalf of the applicant please state in what capacity.**

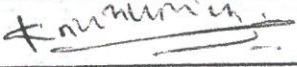
Signed	
Print Name	SANTHOSH PUTHUSSERI
Capacity	
Date	14-09-2015

Where the premises licence is jointly held signature of 2nd applicant or 2nd applicant's solicitor or other authorised agent. (Please read guidance note 12) **If signing on behalf of the applicant please state in what capacity.**

Signed	
Print Name	
Capacity	
Date	

Contact name (where not previously given) and address for correspondence associated with this application. (Please read guidance note 13)					
Title:	Mr	Mrs	Miss	Ms	Mr
Forename(s)	SANTHOSH			Surname	POTHUSSERI
Address for Correspondence associated with this application					
				Post Code	
Telephone Number				Mobile Number	
E-Mail Address					

Notes for Guidance

1. Describe the premises. For example the type of premises, it's general situation and layout and any other information that could be relevant to the licensing objectives. Where your application includes off-supplies of alcohol and you intend to provide a place for consumption of these off-supplies you must include a description of where the place is and its proximity to the premises.
2. Where taking place in the building or other structure please tick as appropriate. Indoors may include a tent.
3. For example state the type of activity to be authorised, if not already stated, and give relevant further details, for example (but not exclusively) whether or not music will be amplified or unamplified.
4. For example (but not exclusively), where the activity will occur on additional days during the summer months.
5. For example (but not exclusively), where you wish the activity to go on longer on a particular day, e.g. Christmas Eve.
6. Please give timings in 24-hour clock format (e.g. 16:00) and only give details for the days of the week when you intend the premises to be used for the activity.
7. If you wish people to be able to consume alcohol on the premises please tick on. If you wish people to be able to purchase alcohol to consume away from the premises please tick off. If you wish for people to be able to do both please tick both.
8. Please give information about anything intended to occur at the premises or ancillary to the use of the premises that may give rise to concern in respect of children regardless of whether you intend children to have access to the premises, for example (but not exclusively) nudity or semi nudity, films of restricted age groups, the presence of gaming machines.
9. Please list here the steps you will take to promote all four licensing objectives together.
10. The application must be signed.
11. An applicant's agent (for example solicitor) may sign the form on their behalf provided that they have actual authority to do so.
12. Where there is more than one applicant, the applicants or their respective agents must sign the application form.
13. This is the address that we shall use to correspond with you about this application.

N

Please highlight any adult entertainment or services, activities, other entertainment or matters ancillary to the use of the premises that may give rise to concern in respect of children (Please read guidance note 8)

O

Hours premises are open to public Standard timings (read guidance note 6)			State any seasonal variations for the supply of alcohol (please read guidance note 4)
Day	Start	Finish	
Mon	06.00	21.00	Non-standard timings. Where you intend to use the premises to be open to the public at different times to those listed in the column on the left, please list (please read guidance note 5)
Tue	06.00	21.00	
Wed	06.00	21.00	
Thurs	06.00	21.00	
Fri	06.00	21.00	
Sat	06.00	21.00	
Sun	06.00	20.00	

P

Describe the steps you intend to take to promote the four licensing objectives:

a) General – all four licensing objectives (b,c,d,e) (See guidance note 9)

1. Inside and outside of the Premises is fully covered by CCTV cameras.
2. Not overstock the shelf
3. Premises shut on time, no deliveries or collections before or after 08.30 ~~17.00~~ Hrs.
4. Strickly advice to the staff not to serve alcohol to the underage customers. to check the age proof ID, flower

Chalage 25.

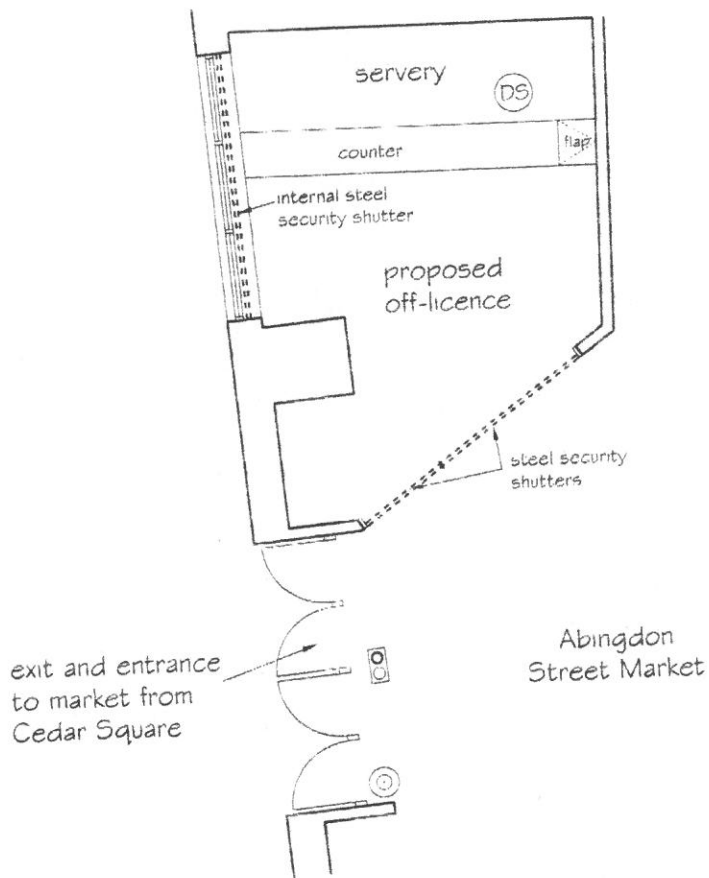

GROUND FLOOR PLAN

FIRE LEGEND

- ⊙ Fire Alarm Call Point
- ⊙ DH Heat Detector
- ⊙ DS Smoke Detector
- 🔊 Fire Alarm Sounder
- ▽ W Water Fire Extinguisher (numerals indicate capacity)
- ▽ DP Dry Powder Extinguisher (numerals indicate capacity)
- ▽ F Foam Extinguisher (numerals indicate capacity)
- ▽ CO₂ Carbon Dioxide Extinguisher (numerals indicate capacity)
- ☐ FB Fire Blanket
- SC Self Closing Door
- PB Panic Bar
- Emergency Light
- ☐◻ Illuminated Fire Exit Sign (directional with arrow)
- ☐ E Fire Exit Sign (directional with arrow)

All fire precautions to be installed to the satisfaction of the Fire Authority

CEDAR SQUARE

ABINGDON NEWS
MR. CAMPBELL

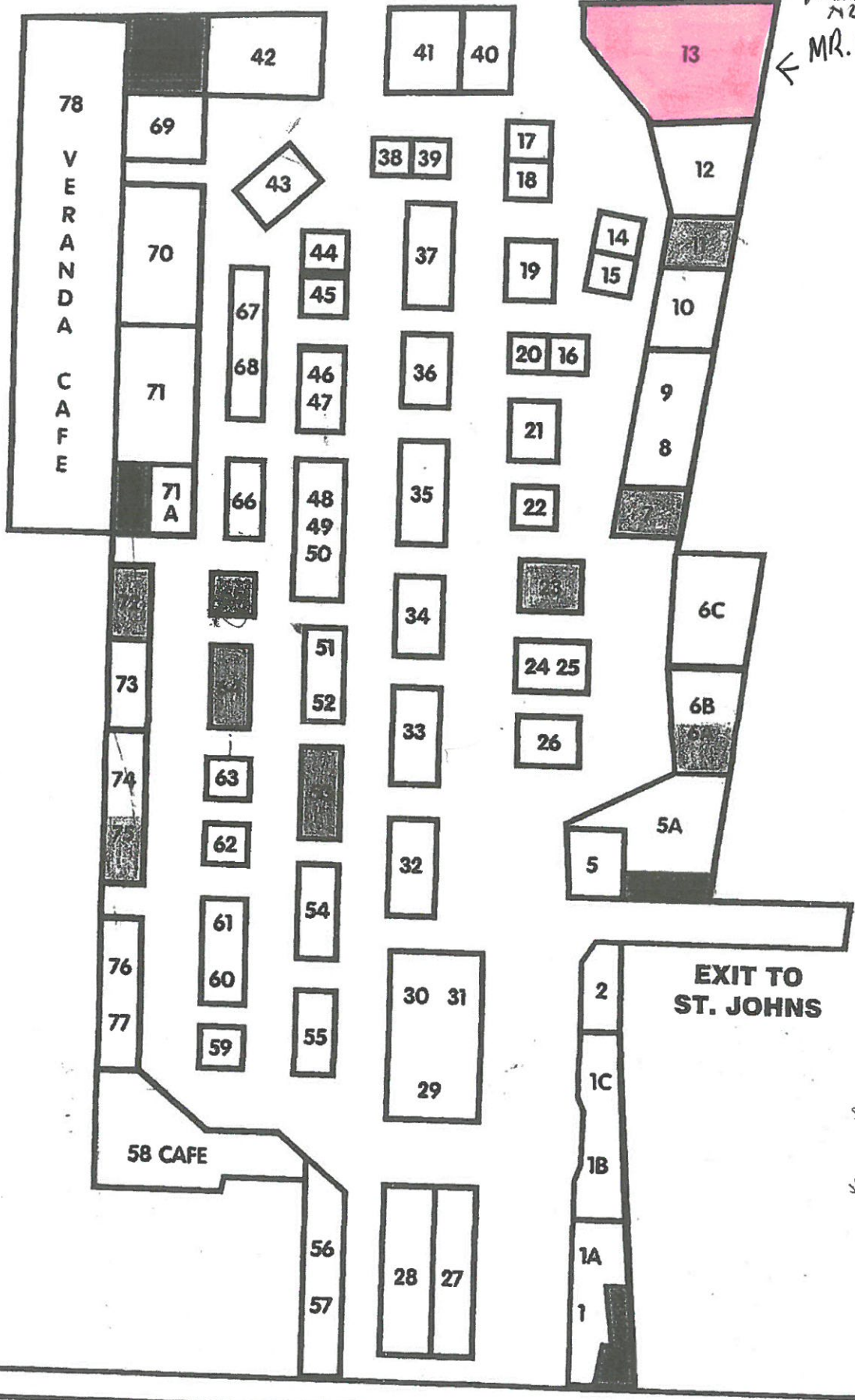

ABINGDON STREET

This page is intentionally left blank

Blackpool Council Licensing Service			
Representation made by a Responsible Authority to an application for the grant / variation of a Premises Licence / Club Premises Certificate			
Responsible Authority			
Name of Responsible Authority	LANCASHIRE CONSTABULARY		
Name of Officer <i>(please print)</i>	PC 3842 Lisa Evans		
Signature of Officer			
Contact telephone number	01253 604000		
Date representation made	15	12	15
Do you consider mediation to be appropriate	<input type="checkbox"/>	<input checked="" type="checkbox"/>	NO
Premises Details			
Premises Name	Abingdon News		
Address	Unit 13, Abingdon Street Market		
	Abingdon Street		
	Blackpool		
Post Code	FY1 1DE		
Reasons for making representations			
<p>I am in receipt of an application for a New Premises Licence for the above address.</p> <p>On behalf of the Chief Officer of Police, having reviewed the application the Police make formal objections on the following grounds:</p> <p>The Police base this objection on the existing Premises Licence being within the Off Licence Saturation Policy Area. The purpose of this Policy is to limit the number of Off Licensed Premises within a given geographic area, in order to reduce crime and disorder and promote the licensing objectives. The Policy sets out the following;</p> <ul style="list-style-type: none"> The number, type and density of the premises selling alcohol in a particular area can lead to serious problems of nuisance and disorder. In these circumstances the impact of the premises taken as a whole can be far greater than that arising from individual 			

premises. In most cases it would be impossible to identify an individual premise as being the sole cause or major contributing factor.

- The potential impact on the promotion of the licensing objections by a significant number of licensed premises concentrated in one area is called cumulative impact. The cumulative impact of all the premises in an area upon the promotion of the licensing objectives is a proper matter for the Licensing Committee to consider.
- This application is within the saturation zone. The location of the proposed premises is in the centre of town, servicing both the day time and night time economy. These premises will only add to the availability of alcohol and increase crime and disorder.

The proposed new premises falls within the Talbot Ward of Blackpool, which is surrounded by Bars, HMO, Hotels, Holiday Flats, and numerous business premises most of these with an alcohol licence.

The Talbot Ward already consists of 25 premises that are Off Licences this is not including the other premises with an alcohol licence.

Talbot Ward already has high levels of Anti Social Behaviour, Violent Crime and Street Drinkers, alcohol is well documented to be a contributing factor to these sorts of issues. Another premises making alcohol easily accessible will only add to the Crime and Disorder.

I also have concerns that the Licence Holder/Designated Premises Supervisor has not been a DPS within the Blackpool Area and therefore has no experience of the area and its surroundings. The applicants address shows as being in Barking and therefore would not be able to commute daily to the premises. I have not been able to find out any previous information in relation to the proposed DPs and therefore cannot comment if he has any previous knowledge of the day to day running of a Licensed premise or if this will be his first role as a DPS and he may not be suitable to take on a high risk premises due to his inexperience.

I have also been made aware that the Premises will still be under the control of the previous licence holders/Dps who were in control of the day to day running of the business when the licence was revoked.

The applicant has also provided a limited amount of conditions covering the four Licensing Objectives and has not stipulated what proportion of the premises will be for the retail of alcohol.

A hearing would allow the Licensing Committee to examine the prospective operators' intentions and rebut the presumption that the operation of the premises will not add to the cumulative impact and therefore crime and disorder.

It is recommended that the licence should only be granted if the application is amended, or if conditions are applied, as detailed below.

Blackpool Council Licensing Service				
Representation made by a Responsible Authority to an application for the grant / variation of a Premises Licence / Club Premises Certificate				
Responsible Authority				
Name of Responsible Authority	Public Health, Blackpool Council			
Name of Officer <i>(please print)</i>	Dr. Arif Rajpura, Director of Public Health			
Signature of Officer	Dr. Arif Rajpura			
Contact telephone number	01253 476363			
Date representation made	14	12	2015	
Do you consider mediation to be appropriate			<input type="checkbox"/>	NO <input type="checkbox"/>
Premises Details				
Premises Name	Abingdon News Unit 13			
Address	Abingdon Street Market			
	Blackpool			
Post Code	FY1 1DE			
Reasons for making representations				
<p>The Public Health Department, Blackpool Council, write in reference to the new Premises Licence application for Abingdon News Unit 13 Abingdon Street Market, Blackpool</p> <p>The applicant brings this application in full knowledge that this store is located within Talbot ward which has been subject to the Cumulative Impact Policy (CIP) since 2009.</p> <p>As stated in Blackpool Council's Statement of Licensing Policy –</p> <p>The effect of the policy is to create a rebuttable presumption that applications listed above will be refused. To rebut this presumption, an applicant would be expected to show through the operating schedule, and where appropriate, with supporting evidence, that the operation of the premises will not add to the cumulative impact already being experienced.</p> <p>Following review of this application, Public Health, Blackpool Council, make a formal objection due to the following concerns:</p>				

Supply of Alcohol

Public Health has concerns that the applicant has applied to supply alcohol from 8.30am; if this application is successful this will increase the availability of alcohol supply within the Saturation Area in the early morning period. Public Health has concerns that this new premises is situated in an area where there are also a large number of premises that sell alcohol (on and off sales) within close proximity to Abingdon Street.

The protection of children from harm

Public Health has concerns that the applicant does not give consideration to steps they will take to promote the licensing objectives. The ground floor plan proposed does not identify where the alcohol will be displayed. It is the authorities' view (as stated in the Blackpool Council Statement of Licensing Policy - 2015-2019) that:

- alcohol displays should not be located at the entrance/exits points to the premise,
- in aisles which interfere with customer flow
- in close proximity to products which are attractive to children, such as sweets and children's magazines.

The unit is located on the entrance to the main market hall and it is of concern that if alcohol displays are to be positioned at the front of this premise the products will be visible to children even if they are not entering the premise but merely walking past this premise within the market hall.

Sale of low value/high alcohol products and any drinks discounting

Within the Operating Schedule the applicant has not stated their policy on the sale of low value/high alcohol products and any drinks discounting that would be adopted. Once again the sale of cheap high strength alcohol and discounted offers within this premise could have a negative impact on the licensing objectives - Crime and Disorder and Public Nuisance; due to the local demographics and potential clientele groups.

Local Area Concerns

In addition under Section 182 of the Licensing Act 2003, Para.8.34, applicants are expected to demonstrate their knowledge of local issues and what they will do to adopt strategies to avoid the exasperation of such issues. The application is completely void of this important information. The applicant demonstrates an inadequate understanding of the area and had failed to demonstrate in their application that their operation would not add to the existing issues already impacting on this area. Paragraph 8.37 of the Section 182 rightly suggests that information to applicants should be readily available; both Blackpool Health Profile 2014 and the Blackpool Drug and Alcohol Health Needs Assessment are public documents which are available yet have not been considered by the applicant.

As stated in the Statement of Licensing Policy the burden of proof rests with the applicant in

this case.

Paragraph 9.30 of the Section 182 suggests that it is good practice for applicants to contact the Responsible Authorities before formulating their application. No contact from the applicant has been received.

Public Health would ask the Licensing Committee to consider the potential risks associated with the increase in the availability of alcohol within this Saturation Area in their deliberations as to whether to grant this application.

For New / Variation Applications only.

It is recommended that the licence should only be granted if the application is amended, or if conditions are applied, as detailed below.

N/A

This page is intentionally left blank

Blackpool Council Licensing Service**Representation made by a Responsible Authority****Responsible Authority**

Name of Responsible Authority

Licensing AuthorityName of Officer *(please print)*

Mark Marshall

Signature of Officer

Contact telephone number

01253-478493

Date representation made

16**12****2015**

Do you consider mediation to be appropriate

YES**NO****Premises Details**

Premises Name

Abingdon Street Market unit 13

Address

Abingdon Street

Blackpool

Lancashire

Post Code

Details of your representation (Please refer and attach any supporting documentation)

I submit this representation on behalf of the Licensing Authority, the premises sits within Talbot Ward which is subject to a special policy where the presumption is to refuse the application.

Blackpool has 4 wards subject to the same test but Talbot ward has the greatest number of Off Licence outlets with 25. The next highest being Bloomfield with 23..

The application is limited in content and does not deal with many of the issues that prevail in the area such as;

Alcohol dependency

Street Drinkers

High Strength Alcohol

Underage sales and consumption

Proxy Sales

The level of crime in the area which has an alcohol related element is significant and there is a clear correlation between the excessive availability of alcohol and crime in the area as such the Committee should be minded to refusing this application which would be supportive of their own Statement of Licensing Policy

The application seeks to purport that the client base is elderly and causes no problems, documented problems of Street Drinkers in the area who enter the market can be evidenced and the previous licence holder was subject to a review for problems in connection with the issue of street drinkers.

I have concerns that this applicant may not be truly independent of the former licence holder as Mr Ghandi is tied to a lease for the stall till May 2017, the matter of transferring the lease and or terminating the agreement has been raised with the Market management but it would require a lump sum payment of £2100. To be paid to the Market before 19th December 2015. To date (16th December 2015) this payment has not been made.

There is also no guarantee that the Market will accept the applicant as a tenant as insufficient ID and credentials have been produced which mean that Mr Ghandi would remain to be the lease holder, for this reason he would have an unhealthy influence as to how the business operated if the licence was granted to the new applicant.

True independence and severance from the former Licence Holder has not been demonstrated and with the former Licence holder being in the background I would have concerns that all the Licensing Objectives would be undermined.

For New / Variation Applications only.

It is recommended that the licence should only be granted if the application is amended, or if conditions are applied, as detailed below.

Blackpool Council Licensing Service
Representation made by a Responsible Authority

Responsible Authority

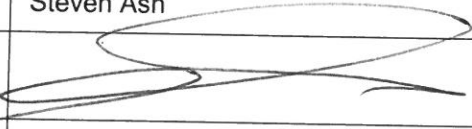
Name of Responsible Authority	Weights and Measures		
Name of Officer <i>(please print)</i>	Steven Ash		
Signature of Officer			
Contact telephone number	01253 478388		
Date representation made	20	11	15
Do you consider mediation to be appropriate	<input type="checkbox"/>	<input type="checkbox"/>	<input checked="" type="checkbox"/> NO

Premises Details

Premises Name	Abingdon News
Address	Stall 13
	Abingdon Street Market
	Blackpool
Post Code	FY1 1DE

Details of your representation (Please refer and attach any supporting documentation)

The statutory Amended Guidance issued made under section 182 of the Licensing Act 2003 suggests the following:

- The DPS is the key person who will usually be charged with day to day management of the premises by the premises licence holder.

And

- The DPS will provide an essential point of contact for police, fire officers or licensing authority officers so that problems can be dealt with swiftly.

I am objecting to this application on the grounds that the proposed Designated Premises Supervisor lives in Barking and is no position to react to anything requiring his presence. I have observed that the previous DPS, Mr Gandhi, on numerous occasions, still effectively running the shop and I am concerned that as the premise licence was revoked while the shop was under his control, he would be effectively be awarded his licence back. I tentatively suggest that if the licence were to be granted the issues that caused the licence to be revoked previously would resurface.

**For New / Variation Applications only.
It is recommended that the licence should only be granted if the application is amended, or if conditions are applied, as detailed below.**